

## KÖCO adapter stud AB 16 x 140- data sheet

**Use:** KÖCO adapter studs serve as spacers to connect steel components, especially sheet piles with threaded reinforcing bars. In this way, the formwork is screwed together with the sheet pile reliably and with high strength in constructing concrete covers. The stud is welded onto the sheet pile within approx. 0.5 seconds by the proven KÖCO drawn-arc stud welding process. If carried out correctly, the load capacity of the weld is higher than that of the stud and the sheet pile.

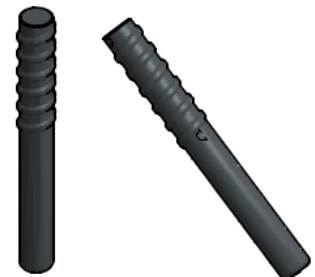

Schweißzugabe = welding allowance  
 Al-Kugel Ø2,77mm = al-ball Ø2.77 mm

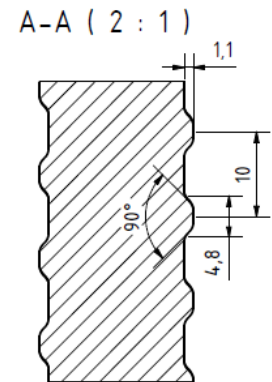
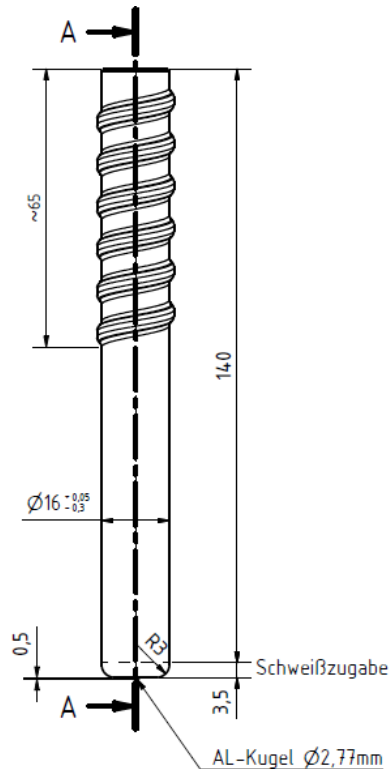

**Material:** Weldable structural steel with the attributes shown in the table below:

Material	Diameter	Length	Breaking strength	Fracture elongation
S235J2+C470	16 mm	140 mm	Min. 95 kN	> 10%

Breaking strength and fracture elongation values were established by tensile testing according to EN ISO 6892-1.

### Instructions for use:

The welded stud can be bent if required. In that case, however, the load capacity may be lower than shown in the table, so the user needs to check it by testing. For thin sheet piles, a punching shear verification may be necessary (risk of punching). When welding a stud close to the upper edge of the pile sheet, the risk of local warpage must be taken into account.

Safe use is the sole responsibility of the user.

For any further information, our application technology engineers will be glad to assist you.

